



*Commencement
Program*

MILLERSVILLE UNIVERSITY



The One Hundred and Sixty-Sixth Annual Commencement

Doctoral, Master's and Undergraduate Degree Candidates

Sunday, the Eleventh of December
Two Thousand Twenty-Two

MILLERSVILLE UNIVERSITY OF PENNSYLVANIA
MILLERSVILLE, PENNSYLVANIA

Order of Exercises

DANIEL A. WUBAH, PH.D., President
Presiding

*ACADEMIC PROCESSION

"Pomp and Circumstance"
Sir Edward Elgar

MILLERSVILLE UNIVERSITY
BRASS QUINTET
Jennifer Jester, D.M.A., Conductor

WELCOME

GAIL E. GASPARICH, PH.D.
Senior Vice President for Academic Affairs
and Provost

*THE NATIONAL ANTHEM

Words by Francis Scott Key
Arranged by John Philip Sousa

LED BY CHRISTINA FLORES '23

INTRODUCTION OF PLATFORM GUESTS

PROVOST GASPARICH

GREETINGS FROM FACULTY

KELLY M. BANNA, PH.D.
Associate Professor, Psychology
President, APSCUF - MU

GREETINGS FROM STUDENT GOVERNMENT ASSOCIATION

LINDSAY GRIFFITHS '23
President, Student Government Association

PRESENTATION OF SENIOR CLASS GIFT

HOLLY WINEGAR '22

GREETINGS FROM GRADUATE STUDENT

CAMILLE HOPKINS '93, '99M,
'04M, '22 ED.D.
Graduate Student Association

MOMENT OF REFLECTION

CHRISTINE PERSUN '17, '22 M.ED.
Graduate Student

SALUTATION TO GRADUATES

DANIEL A. WUBAH, PH.D.
University President

INTRODUCTION OF COMMENCEMENT SPEAKER

PRESIDENT WUBAH

COMMENCEMENT ADDRESS

BRENT D. FREY '83
Retired Director of Worldwide Education
Leadership and Learning, at Apple, Inc.

PRESENTATION OF PRESIDENT'S MEDALLION

PRESIDENT WUBAH

PRESENTATION OF DOCTORAL DEGREE CANDIDATES

JAMES DELLE, PH.D.
Dean, College of Graduate
Studies and Adult Learning

KINDLY SILENCE ALL ELECTRONIC DEVICES AND CELL PHONES DURING THE CEREMONY.

CONFERRING OF DOCTORAL DEGREES

PRESIDENT WUBAH

PRESENTATION OF MASTER'S
DEGREE CANDIDATES

DR. DELLE

CONFERRING OF MASTER'S DEGREES

PRESIDENT WUBAH

PRESENTATION OF ASSOCIATE
AND BACCALAUREATE DEGREE CANDIDATES

PROVOST GASPARICH

CONFERRAL OF DEGREES

PRESIDENT WUBAH

PRESENTATION OF CANDIDATES FOR COLLEGE
OF ARTS, HUMANITIES AND SOCIAL SCIENCES

IEVA ZAKE, Ph.D.
Dean, College of Arts, Humanities
and Social Sciences

PRESENTATION OF CANDIDATES FOR COLLEGE
OF EDUCATION AND HUMAN SERVICES AND
SCHOOL OF SOCIAL WORK

LARA WILLOX, Ph.D.
Dean, College of Education and Human Services
and School of Social Work

PRESENTATION OF CANDIDATES FOR COLLEGE
OF SCIENCE AND TECHNOLOGY

MARC HARRIS, Ph.D.
Dean, College of Science and Technology

PRESENTATION OF CANDIDATES FOR
LOMBARDO COLLEGE OF BUSINESS

MARC TOMLIJANOVICH, Ph.D.
Dean, Lombardo College of Business

WELCOME FROM THE ALUMNI ASSOCIATION

MATTHEW OLPHIN '95
President-Elect
Millersville University Alumni Association

CONCLUDING REMARKS

PRESIDENT WUBAH

*THE ALMA MATER

Words by Esther E. Lenhardt, Class of 1910
and Sanders P. McComsey, Class of 1917
Music arranged by Melzer R. Porter

LED BY CHRISTINA FLORES '23
Millersville University Brass Quintet

*ACADEMIC RECESSION

Grand March from Aida
Giuseppe Verdi

MILLERSVILLE UNIVERSITY
BRASS QUINTET

THE AUDIENCE WILL REMAIN IN PLACE UNTIL ALL GRADUATES HAVE RECESSED.

MACE BEARER: Joseph Lynch, Ph.D

GONFALON BEARERS: Marc Felizzi, Ph.D.; Alexandra Hutto, Ph.D.; Jack Ogutu, Ph.D.; Nicole Pfannenstiel, Ph.D.;
Kenneth Smith, Ph.D.

LEAD MARSHALS: Stacey Irwin, Ph.D.; Karen Rice, Ph.D.

MARSHALS: Eric Blazer, Ph.D.; Shaun Cook, Ph.D.; Melissa Mullen Davis, Ph.D.; Michael Douglas, Ph.D.;
Heather Lehman, Ph.D.; Justin Mando, Ph.D.; Curtis Proctor, Ph.D.; Deborah Sigel, M.F.A; Debra Vredenburg-Rudy, Ph.D.

READERS: Janet Bertoni, Ph.D.; Judith Cebra-Thomas, Ph.D.; Jeffrey Gemmell, D.M.A.; Alexandra Hutto, Ph.D.; Lowery Woodall, Ph.D.

CANDIDATES FOR DOCTORAL DEGREES

EDUCATIONAL LEADERSHIP**

Camille Alanna Hopkins
EDD Educational Leadership

Chanda R. Telleen
EDD Educational Leadership

***Joint program with Shippensburg University since 2014.*

CERTIFICATION AND ENDORSEMENT CANDIDATES

Art Instructional I

Anthony William Harp
Amy Lee Hess
Jennifer Schuck
Joyce Williams

Biology Instructional I

Tyler S. Bridgehouse
Christina D. Clawson

Earth Science Instructional I

Curtis Mark Silverwood

Elementary and Secondary School Counselor PreK-12 Education Specialist

Lindsey Marie Eppler
Emily Grace Forry
Natalie Alexis Hertzog
Wayne David Hooper
Sara Danel Richardson
Emily E. Schriver
Meredith Kaitlin Sefcik
Janeen Y. Selfridge
Brendan John Staudt
Jessica L. Zentner

English Instructional I

Jesse Owen Rice
Kathryn Lynn Shaffer

French Instructional I

Lauren A. Eyler

German Instructional I

Dana Ginder Sick

Gifted Education PreK-12 Endorsement

Ashlie Jean Crosson
Bethany A. Eaton
Roxanna Christine Everly
Stacy Pierce Gasteiger
Hannah Kaptur
Angela L. Tena

Gifted Education Certificate

Hannah Kaptur

Online Instruction Program PreK-12

Katherine E. Krebs
Rebecca Lynn Maryott
Cameron Tyler Murray

PreK-4, Early Childhood Education Instructional I

Madeline Lynette Bruno
Sara Nicole Herbst
Brittany Kortright
Alina Latshaw
Kristen Bennett Thomas
Rachael Kathryn Thomas
Ashley Weatherby

Principal K-12 Administrative

Dawn L. Eby
Patrick Corrigan Muench
Amber J. Owen

Reading Specialist Instructional I

Kelli Anne Barron
Heidi L. Melleby
Megan Elizabeth Murphy
Ashleigh Linn Posch

School Guidance Services-Supervisory

Christina Lampo

School Nurse Education Specialist

Lisa M. Andrews
Sandra Lee Dunn
Haley Jane Irvin
Cerissa Anne Kleinfelter
Jennifer Marie Mausser
Christy Marie Nobile
Jillian Seese

School Psychologist Education Specialist

Isabelle Baumgartner
Katlyn Michelle Bennett
Sabrina Eisele
William J. Halko
Georgia Saldana Jones
Madisan J. Mark
Kim Leigh Neptune
Christina M. Powley
Daniela J. Prisco
Elizabeth G. Sager
Carlos Henry Soto
Alyssa Jory Sunday
Danielle M. Taylor
Gabrielle M. Vaxmonsky
Sadie N. Wentland

School Social Worker PreK-12 Education Specialist

Morgan Lea Yoder

Social Studies Instructional I

Brandon Michael Gregor
Ryan James Guidos
Louis J. Vitale
Robert Joseph Wildasin

Spanish Instructional I

Waylon Brown
Lauren A. Eyler
Elizabeth M. Roderick

Special Education 7-12 Instructional I

Andre David Dyer
Emily Wryk

Special Education PreK-8 Instructional I

Brittany Kortright
Ashley Weatherby

Special Education-Supervisory

Jessica Cunningham

STEM PreK-12 Endorsement

Chelsea Lynne Connelly
Jessica Knoll
Rebecca Lynn Maryott
Mia E. Rowan
Jennifer Lynn Schnabel
Madison Elizabeth Stambaugh

CANDIDATES FOR MASTER'S DEGREES

COLLEGE OF ARTS, HUMANITIES AND SOCIAL SCIENCES

ART

Bonnie Elizabeth Watts
MED Art Education

ENGLISH

Wendy Ann Gensimore
MA English

Eugene J. Kobielnik
MA English

Kara Elizabeth Travis
MA English

HISTORY

Jordan D. Ames
MA History

COLLEGE OF EDUCATION AND HUMAN SERVICES AND SCHOOL OF SOCIAL WORK

ASSESSMENT, CURRICULUM AND TEACHING

Shelbie Berger
*MED Assessment, Curriculum and Teaching
Integrative STEM Education*

Michael Ryan Brown
*MED Assessment, Curriculum and Teaching
Online Instruction*

Danielle Marie Croft
*MED Assessment, Curriculum and Teaching
Online Instruction*

Seth Eugene Decker
*MED Assessment, Curriculum and Teaching
Integrative STEM Education*

Marissa Nicole Dolch
*MED Assessment, Curriculum and Teaching
Integrative STEM Education*

Wendy Ann Harriman
*MED Assessment, Curriculum and Teaching
Integrative STEM Education*

Daniel J. Herr
*MED Assessment, Curriculum and Teaching
Online Instruction*

Adam Robert Hinde
*MED Assessment, Curriculum and Teaching
Online Instruction*

Samantha Houser
*MED Assessment, Curriculum and Teaching
Online Instruction*

Bryan Charles Kostukovich
*MED Assessment, Curriculum and Teaching
Online Instruction*

Jenna Lee Marrazzo
*MED Assessment, Curriculum and Teaching
Integrative STEM Education*

Christine Claire Mattiko
*MED Assessment, Curriculum and Teaching
Online Instruction*

Brittany Lyn McMullen
*MED Assessment, Curriculum and Teaching
Online Instruction*

Kimberly J. Mowen
*MED Assessment, Curriculum and Teaching
Online Instruction*

Christine Persun
*MED Assessment, Curriculum and Teaching
Integrative STEM Education*

Maleah Ashlyn Price
*MED Assessment, Curriculum and Teaching
Integrative STEM Education*

Kristin Mae Putt
*MED Assessment, Curriculum and Teaching
Integrative STEM Education*

Nicole B. Shaak
*MED Assessment, Curriculum and Teaching
Integrative STEM Education*

Brian D. Shortes
*MED Assessment, Curriculum and Teaching
Integrative STEM Education*

Ashley Stank
*MED Assessment, Curriculum and Teaching
Online Instruction*

Tyler Michael Wilczek
*MED Assessment, Curriculum and Teaching
Online Instruction*

CLINICAL PSYCHOLOGY

Kiley Emily Bartusek
MS Clinical Psychology

Kayla Brianna Bensch
MS Clinical Psychology

Thresia Mae Casanova
MS Clinical Psychology

Maria Detweiler
MS Clinical Psychology

Dominique Desmond Ford
MS Clinical Psychology

Kayla Mae Forrey
MS Clinical Psychology

Mathilde Trudy Govers
MS Clinical Psychology

Taylor Marie Grant
MS Clinical Psychology

Ryan D. Herrera
MS Clinical Psychology

Kayla Mae Mesaric
MS Clinical Psychology

Tijana Saran
MS Clinical Psychology

Briar Alex Tarbert
MS Clinical Psychology

EARLY CHILDHOOD AND ELEMENTARY EDUCATION

Shelby Rachelle Borislow
*MED Early Childhood and
Elementary Education*

Brittany Kortright
*MED Early Childhood and
Elementary Education*

Matthew Gregory Ortiz
*MED Early Childhood and
Elementary Education*

Sean Michael Rhoads
*MED Early Childhood and
Elementary Education*

Alyssa Rowe
*MED Early Childhood and
Elementary Education*

COLLEGE OF EDUCATION AND HUMAN SERVICES AND SCHOOL OF SOCIAL WORK

Julia Scarborough
*MED Early Childhood and
Elementary Education*

Abigail Ramage Stefanow
*MED Early Childhood and
Elementary Education*

Molly C. VanLeuvan
*MED Early Childhood and
Elementary Education*

Sydney Wagner
*MED Early Childhood and
Elementary Education*

Adrian Rachelle Whitmore
*MED Early Childhood and
Elementary Education*

GIFTED EDUCATION

Christopher Michael Brode
MED Gifted Education

Kelly Ann DiLullo
MED Gifted Education

Deborah K. French
MED Gifted Education

Hannah Kaptur
MED Gifted Education

Tabitha Hushon Krone
MED Gifted Education

Pamela Sieger
MED Gifted Education

LANGUAGE AND LITERACY EDUCATION

Emily Marie Arnold
*MED Language and Literacy Education
Reading Specialist*

Alison Olivia Charles
*MED Language and Literacy Education
Reading Specialist*

Victoria Taylor Diminick
*MED Language and Literacy Education
Reading Specialist*

Georgia E. Emert
*MED Language and Literacy Education
English as a Second Language*

Jennifer L. Ennis
*MED Language and Literacy Education
Reading Specialist*

Lauren Elizabeth Hofer
*MED Language and Literacy Education
Reading Specialist*

Alicia D. King
*MED Language and Literacy Education
Reading Specialist*

Lori A. Kish
*MED Language and Literacy Education
English as a Second Language*

Meghan Elizabeth Kulp
*MED Language and Literacy Education
English as a Second Language*

Haylie Christine McQuillen
*MED Language and Literacy Education
Reading Specialist*

Alison Nicole Medence
*MED Language and Literacy Education
Reading Specialist*

Anna Grayce Molison
*MED Language and Literacy Education
Reading Specialist*

Lindsey Anne Nester
*MED Language and Literacy Education
Reading Specialist*

Kelsey Rian Pritchett
*MED Language and Literacy Education
Reading Specialist*

Patricia Yeager Roseman
*MED Language and Literacy Education
Reading Specialist*

Kamber Schranm
*MED Language and Literacy Education
English as a Second Language*

Sabrina M. Scott
*MED Language and Literacy Education
Reading Specialist*

Kristin J. Van Lenten
*MED Language and Literacy Education
English as a Second Language*

Erin Lynn Weidman
*MED Language and Literacy Education
Reading Specialist*

Jessica Elizabeth Zielinski
*MED Language and Literacy Education
English as a Second Language*

LEADERSHIP FOR TEACHING AND LEARNING

Colin Lee Greenawalt
MED Leadership for Teaching and Learning

Steven A. Lied
MED Leadership for Teaching and Learning

Mikaela Jo Masser
MED Leadership for Teaching and Learning

Benjamin Joseph Mitchell
MED Leadership for Teaching and Learning

Jenna Eliza Philo
MED Leadership for Teaching and Learning

Katharine Marie Rodriguez
MED Leadership for Teaching and Learning

Christopher P. Telesco
MED Leadership for Teaching and Learning

SCHOOL COUNSELING

Virginia Bramley
MED School Counseling

Caitlyn Rose Flint
MED School Counseling

Kaitlin M. Mock
MED School Counseling

Elizabeth Michelle Sanders
MED School Counseling

SCHOOL PSYCHOLOGY

Julie Ann Battaglia
MS School Psychology

Yasmeen Bekhit
MS School Psychology

Hailey M. Butler
MS School Psychology

Anna Sims Clemens
MS School Psychology

Ezinne Enyosiobi
MS School Psychology

Abdaliz Miranda Garcia
MS School Psychology

Kendall Michele Geist
MS School Psychology

Tonji Elizabeth-Bell Grissinger
MS School Psychology

Ryan Joseph Kubicki
MS School Psychology

Katie A. Maharjan
MS School Psychology

Kyle M. Messaros
MS School Psychology

Baily R. Schwandt
MS School Psychology

Christine M. Stulak
MS School Psychology

Madison Tate VanPelt
MS School Psychology

Katherine Walsh
MS School Psychology

COLLEGE OF EDUCATION AND HUMAN SERVICES AND SCHOOL OF SOCIAL WORK

SOCIAL WORK*

Alexis Torres
MSW Social Work

SPECIAL EDUCATION

Kirstin Beaver
MED Special Education

Carrie Ann McGough
MED Special Education

SPORT MANAGEMENT

Thomas Randall Garner
MED Sport Management
Athletic Coaching

Kayla Marie Held
MED Sport Management
Athletic Management

Patrick Sweda
MED Sport Management
Athletic Management

Elizabeth Wardwell
MED Sport Management
Athletic Management

COLLEGE OF SCIENCE AND TECHNOLOGY

EMERGENCY MANAGEMENT

William Jason Burnett
MS Emergency Management

Jeffrey M. Hunsicker
MS Emergency Management

Jeffrey T. Ludwig
MS Emergency Management

Sean William McFadden
MS Emergency Management

Jennifer L. McKinney
MS Emergency Management

Shontell Yvonne Moman
MS Emergency Management

Breanna Malynn Rogers
MS Emergency Management

Michael James Susko
MS Emergency Management

Logan Williams
MS Emergency Management

INTEGRATED SCIENTIFIC APPLICATIONS

Sheila-Ruth Api Ngu
MS Integrated Scientific Applications
Weather Intelligence and Risk Management

Amanda E. Bunn
MS Integrated Scientific Applications
Environmental Systems Management

MATHEMATICS

Laura Leigh Bitts
MED Mathematics

TECHNOLOGY AND INNOVATION

Amber Trunfio George
MS Technology and Innovation
Education Track

Stacey Anne Lorah
MS Technology and Innovation
Education Track

**Joint program with Shippensburg
University since 2006.*

MASTER'S THESES

EUGENE J. KOBIELNIK

Master of Arts in English

B.S. Ed. Millersville University

Thesis: "Eros Masked and Unmasked: Depictions of Women in Cavalier Poetic Speakers"

Thesis Advisor: Dr. Dominic Ording

DOCTORAL DISSERTATIONS

CAMILLE ALANNA HOPKINS

Doctor of Education

B.Ed. Millersville University

M.Ed. Millersville University

Dissertation: "Parent and Central Office Administrator Perceptions of Family Engagement in an Urban School District"

Dissertation Advisor: Dr. Ann Cancilla Gaudino

CHANDA TELLEEN

Doctor of Education

B.S. Albany State College

M.A. University of Minnesota

Dissertation: "Capability of Influence: the Impact of PBIS Implementation Fidelity on Elementary School Teachers' Feelings of Self-Efficacy"

Dissertation Advisor: Dr. Tiffany Wright

GRADUATE COORDINATORS

ART EDUCATION

Leslie Gates, Ph.D.

ASSESSMENT, CURRICULUM AND TEACHING

Oliver Dreon, Ph.D.

DOCTORATE IN EDUCATION

Ann Cancilla Gaudino, Ed.D.

DOCTORATE IN EDUCATIONAL LEADERSHIP

Kelly Rotondo, DNP, RN, SCRNP, CTC

DOCTOR OF SOCIAL WORK

Bertha Saldana De Jesus, DSW

EARLY CHILDHOOD EDUCATION

Beth Powers, Ph.D.

EMERGENCY MANAGEMENT

Sepideh Yalda, Ph.D.

ENGLISH

Nicole Pfannenstiel, Ph.D.

GIFTED EDUCATION

Charlton Wolfgang, Ph.D.

HISTORY

Robyn L. Davis, Ph.D.

INTEGRATED SCIENTIFIC APPLICATIONS

Sepideh Yalda, Ph.D.

LANGUAGES AND CULTURES

Christine M. Gaudry, Ph.D.

LANGUAGE AND LITERACY EDUCATION

Aileen P. Hower, Ed.D.

LEADERSHIP FOR TEACHING AND LEARNING

Tiffany Wright, Ed.D.

Ann Marie Licata, Ph.D.

MATHEMATICS

H. Tyrone Washington, Ph.D.

NURSING

Cayleigh Minter, DNP, CRNP

CLINICAL PSYCHOLOGY

Karena Rush, Ph.D.

SCHOOL PSYCHOLOGY

Lauren Kaiser, Ph.D.

SCHOOL COUNSELING

R. Joseph Behun, Ph.D.

SOCIAL WORK

Laura Brierton Granruth, Ph.D.

SPECIAL EDUCATION

Richard L. Mehrenberg, Ph.D.

SPORT MANAGEMENT

Julie Lombardi, P.E.D.

TECHNOLOGY & INNOVATION

Scott A. Warner, Ed.D.

UNDERGRADUATE HONORS GRADUATES

Millersville University students are awarded honors in three categories: Departmental Honors, Honors College and University Honors. To qualify for Departmental Honors, a student must complete a thesis written under the supervision of a faculty member. In order to graduate from the University Honors College program, a student must not only complete designated honors courses and a thesis, but also maintain a grade-point average of at least 3.35 in all honors coursework. Students graduate with University Honors by virtue of their grade-point average. Those who earn averages between 3.50 and 3.74 graduate *cum laude*; those who earn averages between 3.75 and 3.94 graduate *magna cum laude*; while those who earn averages between 3.95 and 4.0 graduate *summa cum laude*, the highest earned academic honor the University can bestow.

The Reverend Lewis Merwin Hobbs Medallion/Dr. Dominick '53 and Mrs. Helen DiNunzio Award

Seniors who are graduating *summa cum laude* receive this special medallion. The award has been made possible by a gift from Dr. Dominick '53 and Mrs. Helen DiNunzio.

CANDIDATES FOR BACCALAUREATE DEGREES WITH HONORS

DEPARTMENTAL HONORS

ALANNA L. BEZAS – Emergency Management

Thesis Title: “Developing a Sustainable Preparedness Program for Nurses at NYU Langone Health”

Thesis Advisor: Dr. Sepi Yalda

DANIEL M. FOREACRE – Computer Science

Thesis Title: “Simulating A Neuron”

Thesis Advisor: Dr. Jingnan Xie

KELSEY REANNE HECKERT – Math

Thesis Title: “Factor Analysis of Social Science Data Using R”

Thesis Advisor: Dr. Kevin S. Robinson

CHRISTINE A. JIBILIAN – Art

Thesis Title: “Impacts of Equine-Assisted Therapy Through Photography”

Thesis Advisor: Dr. Shauna L. Frischkorn

ANGELIQUE V. MANCINI – Biology

Thesis Title: “Overexpression of Carbonic Anhydrase in the C3 Model Plant, *Arabidopsis thaliana*”

Thesis Advisor: Dr. Ryan L. Wagner

ALEXANDRA N. NEIDERER – English

Thesis Title: “The Scientist Rebellion: The Unconventional Rhetorical Ways in which Scientists Present the Issue of Climate Change”

Thesis Advisor: Dr. Justin Mando

ANAMARIE V. REINEBERG – Biology

Thesis Title: “Transcription Factor Profile of Turtle Neural Crest Cells”

Thesis Advisor: Dr. Judith A. Cebra-Thomas

MADISON N. WHITCOMB – Economics

Thesis Title: “The Highs and Lows of Higher Education Appropriations: A Business Cycle Perspective”

Thesis Advisor: Dr. Sandra J. H. McPherson

GRADUATES OF THE HONORS COLLEGE

Alanna Lyn Bezas

Emergency Management, Magna Cum Laude

Daniel Matthew Foreacre

Computer Science

Kelsey Reanne Heckert

Mathematics, Magna Cum Laude

Christine Alice Jibilian

Psychology, Magna Cum Laude

Angelique Mancini

Biology, Cum Laude

Courtney McCollough

Early Childhood and Special Education, Magna Cum Laude

Madison Nicole Whitcomb

Mathematics, Cum Laude

UNIVERSITY HONORS

SUMMA CUM LAUDE - HIGHEST HONORS

John-Michael Fallatik	Monica Lynn Kerins	Rachel Renee Ritchey
Aaron Heinbaugh	Taylor Reece McKelvy	Megan Rachel Schoener
Justin Jeremiah Horst	Veronica Clare McLean	Gregory Paul Sinclair
Chasity Lynn Johnson	Nasser Nasser	Karen D. Westmoreland

MAGNA CUM LAUDE - HIGH HONORS

Skyler Mae Bemdeserfer	Christine Alice Jibilian	Caitlin Nicole Miller
Alanna Lyn Bezas	Tyler Allen Johns ¹	Joshua Morris
Molly Elizabeth Bushong	Kirstin Demi Jones	Gracie Anne Mummau
Thomás Augusto dos Santos Claro	David Ronald Krak ²	Lizmarie D. Nieves
Hannah Marie Carricato	Nicole Lynn Krueger	Anna Marie Page
Alyssa Diffenderfer	Alexandra Kwiatkowski	Logan Roden-Reynolds
Calista M. Girton	Madison Lynn Leclerc	Michael L. Ruchalski
Megan E. Gockley	Jakob Scott Logan	Marissa Ann Starr
Fernando J. Gratacos	Sara Catherine Luster	Amanda Nichole VanOverbeke
Leah Noelle Gross	Courtney Elizabeth McCullough	Madison Lynn Vaughn
Sanela Gunic	BreAnn Lynn McPhillips	Sophia Walters ¹
Kelsey Reanne Heckert	Brendan McPhillips	Kelly Wetherington
Alison N. Higgins	Isabella Gabrielle Merced	Lyric Williams
		Autumn Riley Zeplo

CUM LAUDE - HONORS

Mikayla Lynne Adams	Janet Theresa Hershey	Brigid A. Reilly
Jamie Lynn Alban	Brianna Meredith Hileman	Anamarie Reineberg
Matthew Scott Baker	Samantha Lou Holmes	Christopher Rettew
Emily Rebecca Boyles	Sarah Elizabeth Hunsiker ¹	Dan Lee Reznik
Mackenzie K. Brose	Lucas Ilgenfritz	Joseph Peter Rittle
Sean Ryan Burke	Faith M. Irwin	Kaitlyn E. Rock
Samantha Elizabeth Cordner	Sara King	Ariandy Ann Roubert
Caitlin Ann Curran	Sydney Marie Krnjaic	Lauryn Shani Simmons
Kirsten Lynn Denardo	Erin Leigh Lavelle	Jenna Stoltzfus
Amy Nicole Denney	Duncan D. Lynn ²	Lia Rose YuYan Toigo
Jason Matthew Derk	Angelique Victoria Mancini	Tram T. Trinh
Sorcha Dundon	Dylon McGrann	Nyasia Star Vasquez
Perla Duran Tavaraz	Michael Melhorn	Nichole Wagner
Timothy C. Fisher	Tara Adelina Murdock	David Joseph Waskiewicz
Emily Elizabeth Gerlach	Kiara Autumn Nabried	Madison Nicole Whitcomb
Phillip Goyette	Brianna Nicole Nelson	Jennie Moua Yang
Emma Claire Hansen	Kayleigh Jordan Ragland	Frank Steven Yanni

¹Winter 2023 Graduate

²Spring 2023 Graduate

CANDIDATES FOR BACCALAUREATE DEGREES

COLLEGE OF ARTS, HUMANITIES AND SOCIAL SCIENCES

Anna Abrams BA Government, Policy, and Law	Lawrance Jeter BSE Social Studies	Lynnea Quintana ¹ BS Speech Communication
Amaury Abreu Leonardo BS Speech Communication	Sara King BA Sociology	Brigid A. Reilly BA Entertainment Technology
William Jacob Anderson ¹ BS Speech Communication	Savanna G. Kolenda BA Sociology	James C. Reilly ¹ BA Art
Christian John Arcarese BS Speech Communication	Connie Kolakowski ¹ BA English	Christopher Rettew BA History
Quinn E. Benner BA Government, Policy, and Law	Tatiana Sawa Komori-Hertz ¹ BS Music Industry	Luke Richardson BS Music Industry
Ava Bowser BA International Studies	David Ronald Krak ² BA Language & Culture Studies	Rachel Renee Ritchey BS Speech Communication
Hannah Marie Carricato BA Multidisciplinary Studies	Alexis Nicole Lamb BS Speech Communication	Olivia Arianna Roberts BA History
Melissa De Jesús Contreras BS Speech Communication	Wendy Li Yuen-Ting BA Art	Logan Roden-Reynolds BA Government, Policy, and Law
Skyler Thomas Cook BFA Art	Jakob Scott Logan BSE Social Studies	Lauren Marie Rogers BS Speech Communication
Brennan Sean Daly BS Media Arts Production	Hunter R. W. Lebo BS Music Industry	Samuel Joseph Rooney BA Government, Policy, and Law
Amy Nicole Denney BA English	Duncan D. Lynn ² BA Anthropology	Kira Serfass BA Sociology
Thomás Augusto dos Santos Claro BS Speech Communication	James A. McKinney BDES Interactive & Graphic Design	Joshua Arthur Douglas Shisler BS Media Arts Production
Perla Duran Tavaréz BA International Studies	Christopher Barron Stone McPartland BA Government, Policy, and Law BA Anthropology	Kathryn Shisler BSE Social Studies
Joel Fagans BDES Interactive & Graphic Design	Brendan McPhillips BA Language & Culture Studies	Michael J. Summerfield\ BDES Interactive & Graphic Design
Rufus A. Fulton BA Government, Policy, and Law	Ashlynn Victoria McQuillen BA English	Trevor Teubner BA Multidisciplinary Studies
Jarin James Gaumer BA Economics	Richard James Mehrenberg BS Media Arts Production	Thelma K. Urey BA Multidisciplinary Studies
Megan E. Gockley BS Speech Communication	Robert Misciagna BA Government, Policy, and Law	Madison Lynn Vaughen BSE Art Education
Katherine Elizabeth Grasser BA Music	Elizabeth Morales BA Sociology	Sophia Walters ¹ BA History
Alexandria Gregson BA English	Gracie Anne Mummau BA History	Emily Wolfe BA Government, Policy, and Law
Lauren Hart BA Sociology	Tara Adelina Murdock BSE Art Education BFA Art	Luke Joseph Ziegler BA Government, Policy, and Law
Hannah Marie Henrichon BA Government, Policy, and Law	Alexandra Nicole Neiderer BA English	
Janet Theresa Hershey BA Entertainment Technology	Raymond Ortega Jr. BA Economics	
Jamie Hudson BA English	Mark Plaugher BA Entertainment Technology	
Sarah Elizabeth Hunsiker ¹ BA Art	Luke Aaron Purcell BS Speech Communication	
Faith M. Irwin BA Entertainment Technology		

COLLEGE OF EDUCATION AND HUMAN SERVICES AND SCHOOL OF SOCIAL WORK

Mikayla Lynne Adams

BA Psychology

Jamie Lynn Alban

BA Social Work

Juliana Carrara

BA Multidisciplinary Studies

Jeovana Avila Gonzalez

BA Social Work

Ajee' Barber

BA Social Work

Tamara S. Bell

BA Social Work

Skyler Mae Bemdeserfer

BA Psychology

Aja Kiara Bookert

BA Social Work

Delaney Noel Bosworth

BSE Early Childhood and
Special Education

Emily Rebecca Boyles

BSE Early Childhood and
Special Education

Serena Brasile

BSE Early Childhood Education

Mackenzie K. Brose

BSE Early Childhood and
Special Education

Giovanna Carin Brown

BA Social Work

Kayla Nicole Burns

BA Social Work

Molly Elizabeth Bushong

BSE Early Childhood Education

Alyssa Skye Celli

BA Psychology

Nathalie Lynne Champaign

BA Psychology

Ann Virginia Clawges

BA Psychology

Drew Savannah Clayton

BSE Early Childhood Education

Samantha Elizabeth Cordner

BSE Early Childhood Education

Nelian Cruz

BA Social Work

Kylie J. Davis

BSE Early Childhood and
Special Education

Jason Matthew Derk

BSE Middle Level Education

Paris Alexandra DiLorenzo

BA Psychology

Jennifer Dohalick

BA Multidisciplinary Studies

Shawn Dolan

BA Psychology

Julia Theresa Dona

BA Psychology

Sorcha Dundon

BSE Early Childhood Education

Brynne Ehrlicher

BA Psychology

John-Michael Fallatik

BA Social Work

Amy M. Galmoff

BA Social Work

Emily Elizabeth Gerlach

BSE Early Childhood Education

Maria Gerovasilis

BA Psychology

Calista M. Girtton

BSE Early Childhood and
Special Education

Rocio Gomez Suarez

BA Social Work

Amanda Lynne Grant

BSE Early Childhood and
Special Education

Fernando J. Gratacos

BSE Early Childhood Education

Leah Noelle Gross

BSE Early Childhood Education

Sanela Gunic

BA Psychology

Alison N. Higgins

BSE Early Childhood and
Special Education

Rachael Kate Hocker

BA Multidisciplinary Studies

Samantha Lou Holmes

BA Social Work

Haley Marie Howes

BSE Early Childhood and
Special Education

Brianne Danae Hurst

BA Social Work

Christine Alice Jibilian

BA Psychology

Chasity Lynn Johnson

BSE Early Childhood Education

Karlee Suplee Johnson

BA Psychology

Kirstin Demi Jones

BSE Early Childhood and
Special Education

Sydney Marie Krnjaic

BSE Early Childhood Education

Alexandra Kwiatkowski

BSE Early Childhood Education

Madison Lynn Leclerc

BSE Early Childhood and
Special Education

Taylor A. Lefever

BSE Early Childhood and
Special Education

Valerie Elizabeth Locke

BSE Early Childhood Education

Sara Catherine Luster

BSE Early Childhood and
Special Education

Tyjeaa Lyons

BA Psychology

Stephanie Grace Magor

BSE Early Childhood and
Special Education

Alina Michelle Maguire

BSE Early Childhood and
Special Education

Larissa Kay Mann

BSE Early Childhood Education

Alexandria Leigh McClelland

BSE Early Childhood Education

Courtney McCollough

BSE Early Childhood and
Special Education

Taylor Reece McKelvy

BA Psychology

Veronica Clare McLean

BSE Early Childhood Education

BreAnn Lynn McPhillips

BSE Early Childhood and
Special Education

Isabella Marie Melito

BA Social Work

Isabella Gabrielle Merced

BSE Early Childhood Education

Caitlin Nicole Miller

BSE Early Childhood and
Special Education

Joshua Morris

BSE Early Childhood and
Special Education

Kiara Autumn Nabried

BSE Early Childhood Education

Lindsay Rae Neeb

BA Psychology

Brianna Nicole Nelson

BSE Early Childhood and
Special Education

Lizmarie D. Nieves

BSE Early Childhood Education

Brittany C. Orwig

BSE Early Childhood Education

Anna Marie Page
BSE Early Childhood and
Special Education

Ashley Marie Perez
BSE Early Childhood Education

Kayleigh Jordan Ragland
BSE Early Childhood and
Special Education

April Raver
BA Social Work

Tessalyn Mae Rehkugler
BA Psychology

Isabella Hope Renzi
BSE Early Childhood and
Special Education

Kaitlyn E. Rock
BSE Early Childhood Education

Hayley M. Rose
BSE Early Childhood and
Special Education

Chelsea Rousseau
BA Social Work

Aleksander Joseph Ryan
BA Multidisciplinary Studies

Mckenna JoAnn Ryan
BSE Middle Level Education

Abdul Sami
BA Psychology

Katelyn N. Schmidt
BA Psychology

Megan Rachel Schoener
BSE Early Childhood Education

Oceane Serrano
BA Psychology

Alexis M. Shelleman
BSE Early Childhood Education

Madisyn Marie Spahr
BSE Early Childhood Education

Marissa Ann Starr
BSE Early Childhood and
Special Education

Monica Steffy
BA Social Work

Jenna Stoltzfus
BSE Early Childhood and
Special Education

Matthew J. Strosser
BS Sport Administration

Elizabeth Marie Sweet
BA Psychology

Amanda Nichole VanOverbeke
BSE Early Childhood and
Special Education

Nyasia Star Vasquez
BA Social Work

Jennifer Mae Voshell
BA Social Work

Taylor Marie Wagaman¹
BA Psychology

LeighAnn Nicole Walsh
BSE Early Childhood and
Special Education

David Joseph Waskiewicz
BSE Early Childhood and
Special Education

Karen D. Westmoreland
BA Social Work

Kelly Wetherington
BSE Early Childhood Education

Anthony C. Wiggins Jr.
BSE Early Childhood Education

Lyric Williams
BSE Early Childhood and
Special Education

Holly Rose Winegar
BSE Early Childhood and
Special Education

Wyatt B. Wingenroth
BS Sport Administration

Jennie Moua Yang
BSE Early Childhood Education

Frank Steven Yanni
BSE Early Childhood Education

Autumn Riley Zeplo
BSE Early Childhood Education

COLLEGE OF SCIENCE AND TECHNOLOGY

Zahra Aldaif
BS Allied Health Technology

Benjamin J. Ambler
BS Applied Engineering &
Technology Management

Matthew Scott Baker
BS Physics

Amanda Ann Barton
BSN Nursing

Michelle Elise Batchelor
BSN Nursing

Alanna Lyn Bezas
BS Emergency Management

Elsie Blair
BS Allied Health Technology

Rachel Elizabeth Boyd
BSN Nursing

Karla J. Buendia
BS Biology

Sean Ryan Burke
BS Biology

Sophonie Calixte
BS Biology

Alexander Carney
BS Biology

Christina Vietha Koy Chhoeun
BSN Nursing

Amanda Marie Clouse
BSN Nursing

Micaela Cole
BS Applied Engineering &
Technology Management

Kelli Alexa Colon
BS Biology

Naomi Evette Coreano
BS Biology

Madison Taylor Criswell
BS Allied Health Technology

Caitlin Ann Curran
BS Biology

Evelyn Dais
BS Applied Engineering &
Technology Management

Kharif N. Dandy
BS Occupational Safety &
Environmental Health

Kirsten Lynn Denardo
BS Biology

Alyssa Diffenderfer
BS Biology

Anthony Thomas Dorazio
BSN Nursing

Kaitlyn Dougherty
BA Sociology

Kendall Grace Inez Dowling
BSN Nursing

Christan Drayton III
BS Allied Health Technology

Bryce Edward Eaby
BS Manufacturing Engineering Technology

Hannah Ellenberg
BSE Technology and
Engineering Education

Morghyn Paige Erney¹
BSN Nursing

Mary Eshelman
BSN Nursing

Daniel Matthew Foreacre
BS Computer Science

Trevor L. Foresta
BS Computer Science

Cole David Forte
BS Biology

Matthew Thomas Giaponello
BS Computer Science

Phillip Goyette BSE Earth Sciences	Christian M. Liberatore BS Computer Science	Celeste Ines Rodriguez BSN Nursing
Christen Marie Granholm BSN Nursing	Joshua Lynn Lourdon BSN Nursing	Claribel Rodriguez De la Rosa BS Biology
Evan Haas BS Chemistry	Kelli A. Lynch BSN Nursing	Benjamin J. Rossi BA Geography
Jeffrey A. Hartung BSE Technology and Engineering Education	Duncan D. Lynn ² BS Biology	Ariandy Ann Roubert BSE Biology
Matthew Ryan Havicon BA Geography	Angelique Victoria Mancini BS Biology	Michael L. Ruchalski BS Computer Science Mathematics
Noah Hawkins BS Applied Engineering & Technology Management	Nathan B. Manns BSN Nursing	Nicholas F. Ruddie BS Allied Health Technology
Kelsey Heckert BS Mathematics	Emmanuel Marinos BS Biology	Alma Sabic BSN Nursing
Aaron Heinbaugh BS Computer Science	Elisabeth Martin BA Earth Sciences	Payton Salsgiver BSN Nursing
Deborah Jean Henny BS Biology	Jerek Martinez-Andujar BS Computer Science	Justin Riley Sellman BS Mathematics
Brianna Meredith Hileman BS Mathematics	Danelle Sheree Mast BS Mathematics	Kyrsten Alexa Shearer BSN Nursing
Kasey Lee Hoffman BSN Nursing	Ian J. Mccamant BS Manufacturing Engineering Technology	John Matthew Shenk BS Computer Science
Justin Jeremiah Horst BS Mathematics	Dylon McGrann BS Computer Science	Christian Shepperson ¹ BS Computer Science
Tyler Allen Johns ¹ BSN Nursing	Michael Melhorn BS Emergency Management	Jacob R. Shugar BS Allied Health Technology
Alexis N. Johnston BSN Nursing	Ryan Menow BS Computer Science	Andrew James Silkwood BS Biology
Mya S. Jones BS Allied Health Technology	Tanner Michael BS Computer Science	Laurny Shani Simmons BS Computer Science
Simon Joseph BS Mathematics	Chelsea Lynne Miles BSN Nursing	Cole Jeffrey Simpson ¹ BS Biology
Fatima Ama Kassama ¹ BS Biology	Mila Miller BSN Nursing	Gregory Paul Sinclair BS Computer Science
Monica Lynn Kerins BS Allied Health Technology	Katrina Nafziger BS Biology	Kyle Brendan Smith BS Manufacturing Engineering Technology
Nicole Lynn Krueger BSN Nursing	Nasser Nasser BS Allied Health Technology	Andrew Thomas Strange BS Biology
Kristina Krupyak BSN Nursing	Jaimie Neidig ¹ BSN Nursing	Shania Sudler ¹ BS Allied Health Technology
Cory Lachmann BSN Nursing	Matthew North BS Computer Science	Jarrett Trexler BS Allied Health Technology
Raymond Lanas BS Applied Engineering & Technology Management	Tara Lynn Novosel BSN Nursing	Tram T. Trinh BS Computer Science
William J. Lander BS Environmental Earth & Ocean Sciences	Amber Otto ¹ BS Biology	Rocio Jhoanna Uruchima BS Allied Health Technology
Nicholas Alexander Landis BA Earth Sciences	Grace A. Parry BSN Nursing	Bobbi Ann VonderHeide BS Biology
Ashlyn D. Lanza BS Biology	Thao Vy N. Phan ¹ BSN Nursing	Brandon Wagner ¹ BSN Nursing
Erin Leigh Lavelle BS Biology	Anamarie Reineberg BS Biology	Katherine M. Wagner BSN Nursing
Ashlynn M. Lennon BS Mathematics	Joseph Peter Rittle BSE Physics	Nichole Wagner BSN Nursing
	Noah Roark BS Applied Engineering & Technology Management	Jenna Nicole Warner BS Biology

COLLEGE OF SCIENCE AND TECHNOLOGY *continued*

Senorajoy Nasia Weddington
BS Emergency Management

Morgan Kate Weidner
BSN Nursing

Kaelyn Weiler
BSN Nursing

Madison Nicole Whitcomb
BS Mathematics

Emma Mary Wright¹
BA Sociology

Grant E. Yost
BA Multi Disciplinary Studies

Jillian Youch
BSN Nursing

Logan Elijah Zug
BS Computer Science

LOMBARDO COLLEGE OF BUSINESS

Andrew Stephen April
BS Business Administration

Logan M. Arnold
BS Business Administration

Cameron Christian Artman
BS Business Administration

Bertha Aupke
BS Business Administration

Kamryn J. Bardo
BS Business Administration

Victoria S. Binkley
BS Business Administration

Alyssa Blouse
BS Information Technology

Robert Edward Bosch
BS Business Administration

Sheree Angela Brown
BS Business Administration

Justin Edward Canale
BS Business Administration

Allen Darnell Chatmon
BS Information Technology

Christopher J. Cuartas
BS Business Administration

Isabella Josephine Fiorenza¹
BS Business Administration

Timothy C. Fisher
BS Business Administration

Logan A. Flammer
BS Business Administration

Ryan James Goganzer
BS Business Administration

Christopher Hamilton
BS Business Administration

Emma Claire Hansen
BS Business Administration

Jason P. Hines
BS Business Administration

Lucas Ilgenfritz
BS Business Administration

Howard Curtis Jones
BS Business Administration

Ryan Michael Jones
BS Business Administration

Dawson Kannenberg
BS Business Administration

Chad Kunkel
BS Business Administration

Stephanie Nicole Lalli
BS Business Administration

Brady Michael Metzler
BS Business Administration

Ronald Allan Minges Jr.¹
BS Business Administration

Raynelda G. Mondesir
BS Business Administration

Adam Caleb Myers
BS Business Administration

Sierra Marie Pontz
BS Business Administration

Jack B. Rafuse
BS Business Administration

Dan Lee Rezyk
BS Finance
Accounting

Asher L. Ruppert
BS Business Administration

Nick Savage
BS Information Technology

Isabella Smith
BS Business Administration

Jack Thai
BS Business Administration

Kathryn Tipton
BS Business Administration

Lia Rose YuYan Toigo
BS Business Administration

Grant Victor
BS Information Technology

Jennifer Tien Vuong
BS Business Administration

Gladys Zurita-Zurita¹
BS Business Administration

GRADUATE WITH ASSOCIATE DEGREE COLLEGE OF SCIENCE AND TECHNOLOGY

Kyri Isir Rossiter
AT Applied Engineering & Technology

Osiana Roy
AT Applied Engineering & Technology

¹Winter 2023 Graduate

²Spring 2023 Graduate

COMMENCEMENT SPEAKER

Brent D. Frey '83

Brent Frey '83 served as Director of Worldwide Education Leadership and Learning at Apple, Inc. for 21 years before he retired in June 2022.

During the last 10 years, he was responsible for building the Apple Professional Learning model, which was instrumental in training well over one million educators around the world virtually during the pandemic. Throughout his career, Frey has guided education and political leaders in effectively using technology for learning. His proudest accomplishment at Apple was building the plan, a team of professionals, and executing the ConnectED initiative, where Apple invested over \$100 million to help the most impoverished schools in the U.S.

Before joining Apple, Frey began his career as a technology education teacher in the Upper Adams School District in 1984. From 1989-1992, he was the assistant principal at Lemoyne Middle School in the West Shore School District, and he then served as director of technology for the district until June 2001. Throughout his career, Frey has used his expertise in educational technology and leadership development for school administrators and technology integration strategies.

Frey graduated with his bachelor's degree in technology education from Millersville University in 1983, and he then earned his Master of Science degree in education administration from McDaniel College in 1989.

Currently, Frey serves on the advisory board for Millersville University's College of Science and Technology and for the Lombardo College of Business.



Brent D. Frey

PRESIDENT'S MEDALLION

Senator Scott Martin '02

Scott Martin is a Pennsylvania State Senator, a small business owner, and a 2002 Millersville alumnus with a sociology and criminal justice degree. After graduating, Martin began working for the Lancaster County Youth Intervention Center, eventually becoming director of the facility. He also served on the Juvenile Detention Centers Association of Pennsylvania and with the Pennsylvania Commission on Crime and Delinquency. He found a passion for speaking to young adults and cofounded "Operation Deterrence."

Martin started the Lancaster chapter of the Campaign Against Sexual Exploitation and abuse of children after being elected Lancaster County Commissioner in 2007. He also helped create the Lancaster County Coalition to End Homelessness, cochairing the effort for eight years.

In 2016, Martin was elected to the Pennsylvania State Senate. He focused on many areas, including education, health care, the environment and more. In 2021, he helped commit \$100 million to fund pediatric cancer research in Pennsylvania. Since its enactment, over 22 states and countries have used Martin's efforts as a template.

Martin has frequently presented to students at Millersville and has also created internship opportunities. As a Marauder, Martin had a notable athletic career as a defensive tackle and was inducted into the Millersville Athletic Hall of Fame in 2007.

In his spare time, Martin volunteers as a youth sports coach in wrestling and football and as a football stadium announcer. He also cherishes his time with his wife, Amber, and their four children.



Senator Scott Martin

BOARD OF GOVERNORS

PENNSYLVANIA'S STATE SYSTEM OF HIGHER EDUCATION

Cynthia D. Shapira
Chair

David M. Maser

Samuel H. Smith

Marian D. Moskowitz

Neil R. Weaver

Robert W. Bogle

Representative Tim Briggs

Tanya I. Garcia, Ph.D.
*Designee for Secretary
of Education*

William Gindlesperger

Eric Hagarty
Acting Secretary of Education

Abigail Hancox

Allison Jones
Designee for Governor Tom Wolf

Senator Scott Martin

Representative Brad Roae

Senator Judith L. Schwank

Zakariya Scott

Larry C. Skinner

Skylar Walder

Governor Tom Wolf

Janet L. Yeomans

COUNCIL OF TRUSTEES

Michael G. Warfel '84
Chairman

Richard L. Frerichs, Ph.D.
'64, '69M
Vice Chairman

Representative
Jordan A. Harris '06
Secretary

Thomas J. Baker '02

Brandon W. Danz '03

Saul W. Fink, Ph.D. '85

Rick Rodgers

Kathryn R. Ross

Amber M. Sessoms, Ed.D. '06,
'08M

Holly L. Trego '98

Madison N. Whitcomb '22
Student Member

Daniel Greenstein, Ph.D.
ex officio

Daniel A. Wubah, Ph.D.
ex officio

Advisors

Kelly M. Banna, Ph.D.
President, APSCUF-MU

Geoffrey E. Beers '96
CEO, Student Services, Inc.

Joyce Denelsbeck King '83
*President, Millersville University
Alumni Association*

Joseph W. Garner '90
*President, Millersville
University Foundation*

Lindsay A. Griffiths '23
*President, Student
Government Association*

Jeri L. Robinson
Chair, Faculty Senate

PRESIDENT'S CABINET

Daniel A. Wubah, Ph.D.
University President

Victor S. DeSantis, Ph.D.
*Vice President for External Relations
and Chief of Staff*

Gail E. Gasparich, Ph.D.
*Senior Vice President for
Academic Affairs and Provost*

Joshua Hartranft
Interim Chief Technology Officer

Debbie C. Newsom, M.B.A.
*Interim Vice President for
Finance and Administration*

Victor E. Ramos, M.B.A.
Vice President for Advancement

Carlos A. Wiley, M.S.
*Chief Diversity and
Inclusion Officer*

Mary Beth E. Williams, Ph.D.
Vice President for Student Affairs

COLLEGES AND DEPARTMENTS

COLLEGE OF GRADUATE STUDIES AND ADULT LEARNING

James A. Delle, Ph.D., Dean

COLLEGE OF ARTS, HUMANITIES AND SOCIAL SCIENCES

Ieva Zake, Ph.D., Dean

Department

Art & Design
Communication & Theatre
Criminology, Sociology and Anthropology
Economics
English and World Languages
Government, Policy & Law
History
Music
Philosophy

Chairperson

Shauna L. Frischkorn, M.F.A.
Lowery Woodall III, Ph.D.
Marlene S. Arnold, Ph.D.
Kenneth W. Smith, Ph.D.
Kim L. McCollum-Clark, Ph.D.
Richard A. Glenn, Ph.D.
Erin J. Shelor, Ph.D.
Micheál B. Houlihan, Ph.D.
John Kaiser Ortiz, Ph.D.

COLLEGE OF EDUCATION AND HUMAN SERVICES AND SCHOOL OF SOCIAL WORK

Lara Willox, Ph.D., Dean

Marcia V. Bolton, Ed.D., Associate Dean

Department

Early, Middle & Exceptional Education
Educational Foundations
Psychology
Social Work
Wellness & Sport Sciences

Chairperson

Richard L. Mehrenberg, Ph.D.
Tiffany E. Wright, Ed.D.
Debra S. Vredenburg-Rudy, Ph.D.
Karen M. Rice, Ph.D.
Daniel J. Keefer, Ph.D.

COLLEGE OF SCIENCE AND TECHNOLOGY

Marc Harris, Ph.D., Dean

Department

Applied Engineering, Safety & Technology
Biology
Chemistry
Computer Science
Earth Sciences
Geography
Mathematics
Nursing
Physics

Chairperson

Leonard S. Litowitz, Ph.D.
Ryan L. Wagner, Ph.D.
Aimee L. Miller, Ph.D.
Stephanie M. Schwartz, Ph.D.
Lynn Marquez, Ph.D.
Jessica J. Kelly, Ph.D.
Janet A. White, Ph.D.
Kelly A. Kuhns, Ph.D.
Sean P. Hendrick, Ph.D.

LOMBARDO COLLEGE OF BUSINESS

Marc Tomljanovich, Ph.D., Dean

Department

Accounting and Finance
Management and Marketing

Chairperson

Eric L. Blazer, Ph.D.
David J. DiRusso, Ph.D.

UNIVERSITY COLLEGE

Rachel E. Finley-Bowman, Ph.D., Dean

Department

Academic Advisement & Student Development
University Library

Chairperson

David I. Henriques, Ph.D.
Gregory E. Szczyrbak, M.S.

NON-COLLEGE DEPARTMENTS

Department

Counseling and Human Development
Intercollegiate Athletics

Chairperson

Joseph F. Lynch, Ph.D.
Miles P. Gallagher '10, M.Ed. '12

GREETINGS FROM THE ALUMNI ASSOCIATION PRESIDENT

Dear Graduate,

Today is a milestone moment that will forever resonate in your life. On behalf of the Millersville University Alumni Association, I congratulate you for the dedication and perseverance that advanced you to this day. I am honored to be the first to welcome you into this prestigious group of Marauders for Life.

The MU Alumni Association—founded in 1861 and 73,000 members strong—keeps alumni connected and engaged with their alma mater, no matter where in the world life takes them. I encourage you to bookmark the alumni website, villealumni.com, and follow our social media accounts to keep up with campus and alumni news. You will now have access to some great benefits and services created especially for MU alumni and can learn more about them on our website.

The Office of Alumni Engagement is proud to be your point of connection to the University going forward. Through the alumni network, you can access extended support from the University, tap into its vibrant alumni network and stay connected to your alma mater and one another through Homecoming and other special events and programs. Even long after graduation, your alma mater is here for you and invested in your lifelong growth.

Please stay in touch and keep your contact information updated so we can let you know about all the great things happening with the MUAA! Let us know about your personal and professional accomplishments, including career advancements. We often feature these updates in our University magazine, the Millersville University Review.

We wish you, and your family and friends celebrating with you, sincere congratulations on this remarkable accomplishment.

Be a Marauder for Life!



JOYCE DENELSBECK KING '83

President, Millersville University Alumni Association

villealumni.com | 800.681.1855 | mualumni@millersville.edu

SENIOR CLASS GIFT –

Holly Winegar 2022

There is a long-standing tradition of philanthropy at Millersville University. Since 1866, each graduating class has promoted the spirit of giving by providing students an opportunity to leave their legacy at the university they call home.

The Class of 2022 has embraced this philanthropic spirit by providing a financial donation to the programs, departments and teams that we love and which have had a positive impact on our Millersville experiences.



Millersville University
CAMPAIGN FOR STUDENTS

ABOUT THE UNIVERSITY

A Brief History of Millersville

Millersville has the distinction of being Pennsylvania's first state-owned university, founded in 1855 as a normal school. In the mid-19th century, normal schools were developed throughout the East as a way to train teachers for the country's fast-growing new public schools. In Lancaster County, James P. Wickersham was in charge of the public schools and was convinced of the need for training programs for teachers. He held his own program, a teachers institute, in the little borough of Millersville. After its success, he then convinced the town fathers who had built the school to permit it to be used instead as a permanent normal school.

For the next 100 years, Millersville's purpose was to prepare teachers, and it did so with great success. Its reputation as an institution of excellence was established during the period when it was operating two-year and later four-year programs to prepare the individuals who taught the children of this Commonwealth.

Over the years, the school's name changed several times. Wickersham called it the Lancaster County Normal School. In 1859, when it was four years old, the school was officially recognized by the state legislature, and its name became The First Pennsylvania State Normal School. That lengthy title was gradually changed by usage to Millersville State Normal School. It was known by several other names before 1959, when the name was changed to Millersville State College, and soon to follow were a great many new four-year baccalaureate programs in the arts and sciences. Also added were master's degree programs, at first in teacher education and later in many other fields. On July 1, 1983, the college became Millersville University of Pennsylvania, and the 14 state-owned colleges became the State System of Higher Education.

Millersville University Today

During Millersville's evolution from a normal school to a university, its reputation as a good training ground for teachers has not diminished. Teacher certification programs are available across all schools in Special Education, Elementary and Early Childhood Education, a wide selection of Secondary Education programs, Technology and Engineering Education, Art Education and Music Education.

The College of Education and Human Services is home to the following departments: Educational Foundations; Early, Middle and Exceptional Education; Psychology; and Wellness and Sport Sciences, as well as the School of Social Work.

The College of Science and Technology is comprised of the following departments: Applied Engineering, Safety & Technology; Biology; Chemistry; Computer Science; Earth Sciences; Geography; Mathematics; Wehrheim School of Nursing and Physics. Offerings in the health fields include Respiratory Therapy; Medical Technology; Nuclear Medicine Technology; Pre-Athletic Training; Pre-Med; Pre-Optometry; Pre-Pharmacy and Pre-Podiatry.

The College of Arts, Humanities and Social Sciences is the home of the liberal arts disciplines in humanities and social sciences, including the departments of Art and Design; Communication and Theatre; Criminology, Sociology and Anthropology; Economics; English and World Languages; Government, Policy and Law; History; Language and Culture Studies; and Philosophy, as well as the Tell School of Music. The College also offers interdisciplinary programs in African American Studies, Entrepreneurship, International Studies, Latina/o Studies, and Women's and Gender Studies.

Originally established in 2019, the **Lombardo College of Business** offers majors in Accounting, Business Administration, Finance, Management and Marketing. The College was officially named in 2020 in recognition of Dr. Samuel and Mrs. Dena Lombardo's generosity to both the College and University. This is the first named college in Millersville's 166-year history.

The College of Graduate Studies and Adult Learning was established in fall 2009 following 50 years of graduate program offerings. Today, Millersville offers more than 50 graduate degree and certification programs, and three doctoral programs that serve the needs of adult learners in our community and beyond.

ACADEMIC SYMBOLISM

University College was established at the beginning of the 2022-2023 academic year and is comprised of Academic Advisement and Student Development, the Center for Public Scholarship and Social Change, the Center for Civic Responsibility and Leadership, Experiential Learning and Career Management (ELCM), the Francine G. McNairy Library and Learning Forum, Integrated Studies, Multidisciplinary Studies, the Office of Learning Services, Starfish, Success Coaching, the University Honors College and the Writing Center.

The University's curriculum is continuously studied and adjusted to allow for the development of programs to meet the needs of students. Millersville University's **Multidisciplinary Studies (MDST)** major is an innovative and flexible program of study that allows students to tailor studies to meet their academic strengths and career goals with careful advisement.

Integrated Studies is an individualized postsecondary education course of study for individuals with intellectual disability that leads to social and professional networks, careers and bright futures. Students receive support from trained personnel, including coaches, mentors, faculty and staff.

Millersville's excellent reputation extends beyond the classroom as well. It has outstanding athletic, intramural and recreational programs. It offers a wide range of cultural activities for both educational and entertainment purposes. The Winter Visual and Performing Arts Center houses the Tell School of Music and state-of-the-art facilities, including performance and recital halls, recording suites and piano labs. The Ware Center in downtown Lancaster offers space for academic studies as well as elegant performance areas and cultural events programs.

The 250-acre main campus is well-tended, and the park-like area around the campus pond is regarded as a special place by students where they can sit and enjoy the outdoors and watch the swans, Miller and S'Ville.

All of these factors contribute to a good deal of pride at Millersville University—pride that parents and friends of graduates rightfully share.

Academic ceremonies are steeped in centuries-old ritual. The elaborate trappings contribute to the pageantry and dignity of the occasion, and convey the continuity of academic tradition from medieval times to the present. Incorporating these traditions unites Millersville University with the community of scholars and institutions of higher learning.

THE ACADEMIC PROCESSION

The academic procession that begins and ends most academic ceremonies is a descendant of the clerical procession. Millersville University's procession, formed in ranks of two, is led by one of the most senior faculty carrying the University mace, followed by the candidates for degrees, the University faculty, the Council of Trustees and platform party, and the University president and guest speaker.

THE MACE

The staff carried at the front of the academic procession is called a mace and represents the authority of the Office of the President.

THE UNIVERSITY SEAL

Millersville University's seal, a gift of the Class of 1916, is worn on a gold chain by the University president.

ACADEMIC ATTIRE

The academic regalia has always consisted of three parts: the gown, the hood and the cap. It has traditionally been worn at academic ceremonies as a record of the academic achievement of the participants. Its use originated in the Middle Ages, when all undergraduates were required to wear clerical robes, since students were expected to enter the ranks of the clergy. In this country, a color system was adopted in 1893 to identify the academic discipline in which the degree was earned. Some of the most frequently seen hood colors, and the field of learning represented by each, are white, arts and letters; light blue, education; dark blue, philosophy; golden yellow, science; copper, economics; scarlet, theology; and pink, music. The tassels for bachelor's and master's degrees are usually black, while the tassel of the doctorate cap is usually gold.

Words by Esther E. Lenhardt Class of 1910 and
Sanders P. McComsey Class of 1917

-

THE NATIONAL ANTHEM

32

GYMNASIUM EVACUATION MAP

Pucillo Gymnasium Emergency Exits

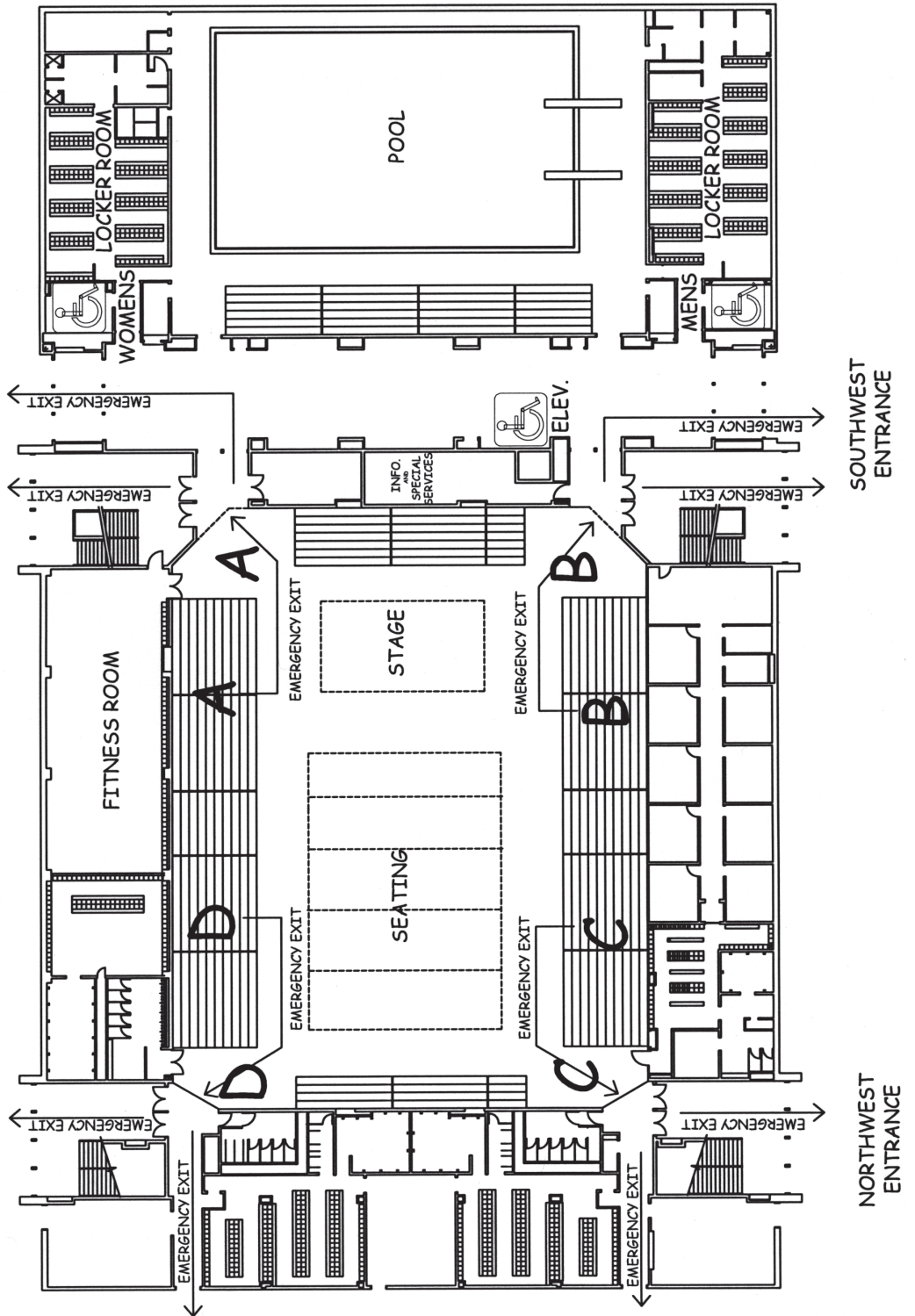

Millersville University