

Millersville University



LANCASTER COUNTY, PENNSYLVANIA, USA





96%
OF GRADUATES
EMPLOYED WITHIN
6 TO 10 MONTHS



MORE THAN 30
PROGRAMS
WITH CO-OPS

RANKINGS BY
**U.S. NEWS &
WORLD REPORT**



#116
IN REGIONAL
UNIVERSITIES NORTH

#42
IN TOP PUBLIC
UNIVERSITIES

#152
TOP PERFORMERS
IN SOCIAL MOBILITY



Music and Art
degree programs are
**NATIONALLY
ACCREDITED**
by NASM and NASAD



Ville Fast Facts



69
NUMBER OF COUNTRIES
REPRESENTED BY
INTERNATIONAL
STUDENTS



**ROBOTICS
INTERNSHIP PROGRAM**
wins STEM award



3 DIFFERENT
STUDENT-RUN
PUBLICATIONS
with opportunities for
literary, journalistic and
research-focused publishing



335

**INTERNSHIP
OPPORTUNITIES**
LAST YEAR ALONE



**MODERN AND SPACIOUS
SUITE-STYLE
RESIDENCE HALLS**



**OUR PARTNERSHIPS
WITH LOCAL EMPLOYERS
PROVIDE A VALUABLE PATH**
through which our students
can launch their careers.



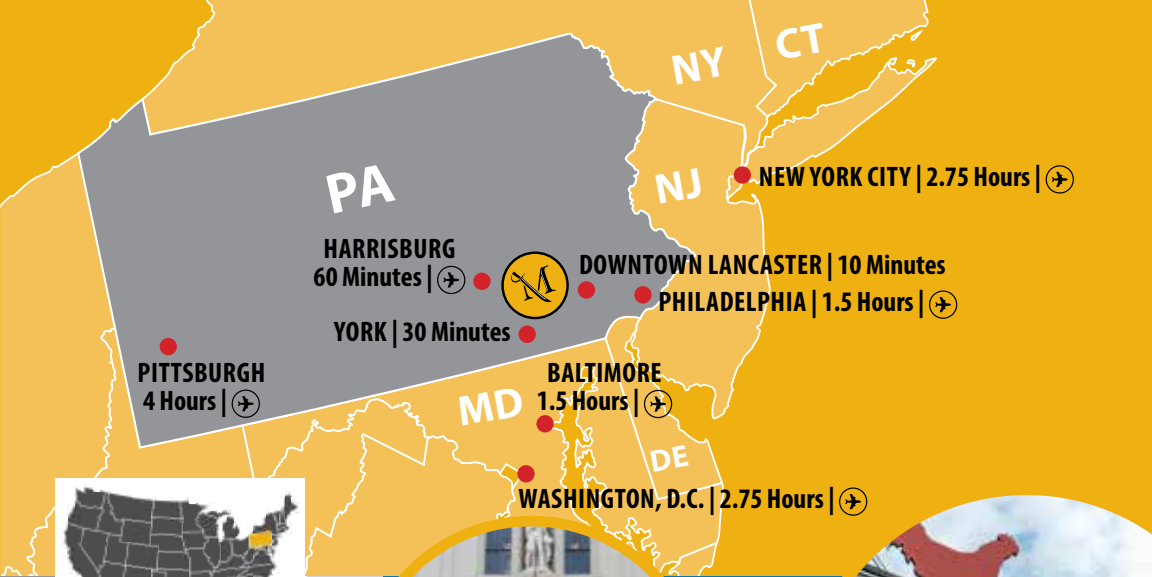

**DOWNTOWN
LANCASTER**



Fulton Theatre



Central Market



Lancaster Train Station



The Ware Center

Downtown Lancaster
is a **10-MINUTE DRIVE**
to food, shopping and
entertainment.

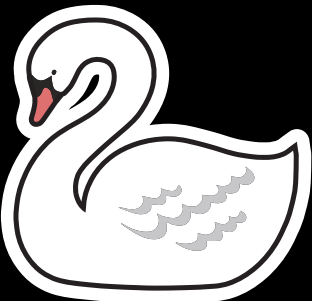



GET INVOLVED AT MU

We thrive on welcoming new members to the community to discover new friendships, passions and talents. With more than 130 clubs and student organizations and 19 Division II NCAA athletic teams, there are always opportunities to get involved, find new passions and meet new friends.





MADE IN MILLERSVILLE

SCAN HERE

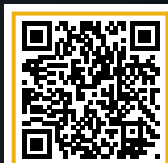

to learn more about
Made in Millersville.

As early as your first year, you are encouraged to participate in the **Made in Millersville** event, where you will showcase your talents, ideas and accomplishments. This event is held annually and is a unique experience for our Marauders, faculty, staff and the community to come together.

Through a wide range of projects, research and creative endeavors, our students gain invaluable skills, knowledge and confidence that set them apart in the competitive landscape of today's job market.



HERE'S TO LIVING AT THE 'VILLE



THE VILLAGES AT MILLERSVILLE UNIVERSITY

Live with other students who share your college lifestyle in a supportive living-learning environment in our East, South and West Village suites. There are single-room and double-room accommodations with semi-private bathrooms, convenient location and all the amenities necessary for establishing your "home away from home." *Kitchens are available.*

Tour Our Housing!



LIVING-LEARNING COMMUNITIES

Located throughout the residence halls, Living-Learning Communities (LLCs) offer eligible students the opportunity to become part of a unique residential experience that connects classroom learning with residence hall life. Students enjoy all the advantages of living on campus with the added benefit of residing among students who share common academic goals and interests. Communities include Business, International Connections, and Women in STEM. Visit millersville.edu/lhc for more information.



Double Suite



Single Suite



Marauder Suite (single rooms)

SHENKS HALL

Three different suite-style options comfortably house two or four students. All units have one in-suite bath per two students, and each suite comes fully furnished.



Suite A



Suite B

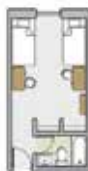

Suite C

DINING OPTIONS AT MU

In addition to cooking at home if you live in the Villages or a Marauder Suite, you will have a number of on-campus and off campus food options.

On campus Millersville operates the Cove, The Anchor, and Upper Deck. Millersville hosts a Starbucks and a Chick-fil-A (opening spring 2025). The Lombardo College of Business proudly supports the Evergreen Cafe, a student run venture. Off campus students can walk to the Sugar Bowl, a local favorite – or go into Lancaster city to have access to over 13 international grocery stores and food options from all over the world.

Learn more about your meal plan options at: millersville.edu/mealplan



The following is what our *alumni* have to say about the impact *Millersville University* had on their lives!



“I chose Millersville because it has a unique combination of affordability and high-quality programs taught by experts in their respective industries.”

— GASSER ABOUSAIF '20, '23M | BUSINESS ADMINISTRATION • M.S. TECH & INNOVATION



“I chose Millersville because it has a quality education and offers a wide range of academic and extracurricular opportunities. With its convenient location near major cities, Millersville makes it easy for students to take advantage of the internships and other career-oriented experiences.”

— YI WANG '23 | BIOLOGY



“During my time at Millersville, I have felt so supported in everything I have done. I have switched my major, found my passion, become a better student and, most importantly, become a better person. I was given the opportunity to present at Made in Millersville, an academic conference on campus, and rose to the position of CFO for the Marauder Fund, which works with investing a portion of the University's endowment.”

— MIHIR SAUDAGAR '20 | ECONOMICS



“I chose Millersville because Millersville offered a master's program in clinical psychology with a hands-on portion, which is how I learn best! I also searched my professor's curriculum and saw that they had a lot of experience that aligned with my values, goals and dreams! Finally, when I visited the campus, everyone was so welcoming and friendly that it felt like the right place for me!”

— REGINA SANCHEZ ALCALDE '23 | M.S. CLINICAL PSYCHOLOGY



“It has been a childhood dream of mine to study in the USA... It has become clear to me that Millersville is an institution that cares for its students and tries to achieve a balance between sports and academics. This made Millersville University a compelling choice for me - a home away from home.”

— QHAYIYA NOGODUKA '24 | B.S. PSYCHOLOGY



120+ MAJORS

U = Undergraduate • G = Graduate • *Available Online • **Minor Available • *Must choose a concentration • **Not available to F or J student visas • *Co-Ops Available

COLLEGE OF ARTS, HUMANITIES & SOCIAL SCIENCES

Anthropology^{^+(U)}

- Archeology⁺

Art^{^ (U)}

Art Education (U, G^{})**

Communication (U)

- Digital Comm and Cultural Studies
- Journalism⁺
- Public Relations
- Theatre⁺

Economics^{^+ (U)}

English^{^ (U, G[°])}

- ESL/Linguistics⁺
- Film Studies⁺
- Writing Studies⁺

Entertainment Technology^{^ (U)}

Government, Policy, and Law^{^+ (U)}

History^{^+ (U, G)}

Interactive & Graphic Design^{^+ (U)}

International Studies^{^+ (U)}

Language & Culture Studies

- Culture Studies Spanish
- Language Studies Spanish
- Teacher Education Spanish

Media Arts Production^{^+ (U)}

Music^{^+ (U)}

- Music Performance

Music Education^{^ (U)}

Music Industry^{^ (U)}

- Live Audio Production
- Music Management
- Music Production

Philosophy^{^+ (U)}

Sociology^{^+ (U)}

- Criminology⁺

Multidisciplinary Studies^{^ (U)}**

- Humanities
- Social Sciences: Economics
- Social Sciences: Government
- Social Sciences: History
- Latinx and Latin-American Studies⁺
- Science Writing⁺

Information Technology^{^+ (U)}

- Cybersecurity⁺

Management^{^+^ (U)}

- Human Resource Management

Marketing^{^+^ (U)}

Multidisciplinary Studies^{^ (U)}**

- Business Analytics
- Entrepreneurship⁺

COLLEGE OF EDUCATION & HUMAN SERVICES

Assessment, Curriculum & Teaching (G^{})**

- Integrative STEM Education⁺
- Online Instruction

Behavioral and Human Services^{^ (U)}

Educational Leadership (G^{})**

Early Childhood (U, G[°])

Gifted Education (G^{})**

Language & Literacy Education (G[°])

- ESL⁺
- Reading Specialist

Leadership for Teaching and Learning (G)

- Music Concentration

Middle-Level Education (U)

- Math
- Language
- Science
- Social Studies

Psychology^{^+ (U, G)}

- Clinical
- School Psychology

School Counseling (G)

School Psychology (G)

Social Work^{^+ (U, G)}

Special Education (U, G[°])

Sport Administration (U)

- Sport Business

Sport Management (G)

- Athletic Coaching⁺
- Athletic Management

Multidisciplinary Studies^{^ (U)}**

- Applied Disability Studies
- Educational Studies

COLLEGE OF BUSINESS

Accounting^{^+ (U)}

Business Administration^{° (U)}

- International Business
- General Business⁺

Finance^{^+ (U)}

- Wealth Management

COLLEGE OF SCIENCE & TECHNOLOGY

Applied Engineering & Technology

Management^{^* (U)}

- Advanced Manufacturing Technology⁺
- Computer-Aided Drafting & Design⁺
- Construction Management

- General Technology
- Graphic Communication
- Robotics & Control Systems

Allied Health Tech

- Medical Technology
- Sports Medicine
- Nuclear Medicine Technology
- Respiratory Therapy

Applied Engineering & Technology^{^*} (U) (Assoc.)

- Advanced Manufacturing Technology
- Computer-Aided Drafting & Design
- Construction Technology⁺
- Control Systems Technology⁺
- Graphic Communications
- Occupational Safety

Automation & Robotics Engineering Tech[^] (U)

Biology^{^*} (U)

- Animal Behavior
- Environmental Biology
- Marine Biology
- Medical Technology
- Molecular Biology/Biotechnology⁺
- Nuclear Medicine Technology
- Plant Sciences
- Respiratory Therapy

Chemistry^{^*} (U)

- Biochemistry⁺
- Environmental Chemistry⁺
- Nanotechnology
- Polymer Chemistry
- Pre-Pharmacy
- Engineering Instrumentation Automation

Computer Science^{^*} (U)

Earth Sciences^{^*} (U)

Emergency Management^{^*} (U, G)

Environmental and Spatial Sciences (U)

Environmental Earth and Ocean Sciences (U)

- Environmental Earth
- Environmental Geology⁺
- Environmental Ocean

Environmental Earth Systems Management (G^{*})**

Geography^{^*} (U)

- Environmental Studies
- Global Studies⁺
- Geospatial Applications
- Sustainability Studies

- Social Studies

Integrated Scientific Applications[^] (G^{*})**

- Climate Sci Applications
- Environmental Systems Management
- Geoinformatics

Weather Intelligence and Risk Management

Manufacturing Engineering Technology[^] (U)

Mathematics^{^*} (U, G)

- Actuarial Sciences
- Applied Math
- Statistics⁺

Meteorology⁺ (U)

Nursing (U^{*}, G^{***})**

- Family Nurse Practitioner
- Nursing Informatics
- Nursing Leadership
- School Nursing

Occupational Safety and Environmental Health^{^*} (U)

Physics^{^*} (U)

Space Weather and Environment (G^{*})**

Technology & Innovation^{^*} (G)

- Education
- Enterprise

Technology and Engineering Education (U)

- Design Education

Multidisciplinary Studies^{^*} (U)

- Data Science^{^*}

EXPLORATORY STUDIES (U)

Undecided w/ less than 45 credits

PRE-PROFESSIONAL OPTIONS

- Pre-Athletic Training
- Pre-Law
- Pre-Occupational Therapy
- Pre-Optometry
- Pre-Podiatry
- Pre-Med
- Pre-Dental
- Pre-Vet
- Pre-Pharmacy

80+ MINORS

- Environmental Policy & Regs
- Fine Art Metals
- Geospatial Applications
- Gerontology
- Graphic Communication Technology

- Heliophysics & Space Weather
- Hydrology
- Industrial Environmental Health
- Oceanography
- Photography
- Quantitative Methods

- Social Justice
- Studio Art
- Sustainability Studies
- Technical Economics
- Women Gender & Sexuality And more!

VILLE NATION

TUITION

2024-2025 ANNUAL TUITION AND FEES			
	UNDERGRADUATE	GRADUATE	ENGLISH LANGUAGE INSTITUTE
Tuition and Fees	\$22,232	\$16,874	\$11,125**
Living Expenses*	\$12,600	\$12,600	\$12,600
Health Insurance	\$750	\$750	\$750
Books and Miscellaneous Expenses	\$1,400	\$1,400	\$1,400
Total Expenses	\$36,982	\$31,624	\$25,175

Tuition and fees based on a flat-rate model for undergraduate, 6 credits for graduate, and 20 hours for ELI.

*Includes a shared room and a standard meal plan. Transfer and graduate students may choose other room and meal-plan options.

**The English Language Institute does not charge tuition; instead, there is a Program Charge.

FUNDING YOUR EDUCATION

MERIT-BASED SCHOLARSHIPS

All first-year undergraduate international students are automatically eligible for merit scholarship consideration. Awards for the Fall 2025-Spring 2026 academic year will be set by October 2024. Scholarship eligibility is based on a US 4.0 weighted GPA.

GRADUATE ASSISTANTSHIPS (GA)

A tuition waiver of 18 credits per year and a stipend of \$6,000 per year are awarded to fulltime, first-year GAs. Part-time graduate assistantships would work 10 hours per week in the position and receive half of the tuition waiver and stipend.

CAMPUS EMPLOYMENT

International students may work on campus up to 20 hours per week while enrolled, with a potential to earn between \$1,920 and \$9,600 annually depending on position, hours and shifts worked.

TUITION PAYMENT PLAN

Plans break down your tuition balance into three to five affordable monthly payments. There's no interest, payment options are flexible, setup fees are affordable and it's easy to enroll! There is a \$30 nonrefundable enrollment fee per semester.

HOW TO APPLY

ENGLISH LANGUAGE INSTITUTE ONLY

- Online application (*for international students*)

UNDERGRADUATE (UG) ADMISSIONS

All undergraduate international students applying to Millersville University are required to submit the following:

- Online application (*for international students*)
- Official transcripts issued in original language*
- Official English translation required (*if applicable*)
- Demonstration of English proficiency

*Copies are acceptable for issuing an admission decision, but official copies from the issuing institution are required for enrollment. External evaluation not required.

GRADUATE (G) ADMISSIONS

All graduate international students applying to Millersville University are required to submit the following:

- Online application (*for international students*)
- Official transcripts issued in original language*
- Official English translation required (*if applicable*)
- Demonstration of English proficiency
- Goal statement (*statement of purpose*)
- Graduate admission test (*where applicable*)
- 3 Recommendation letters or forms
At least 1 Academic (*where applicable*)
- Additional items vary by program

ELI, ENGLISH REQUIREMENTS & CONDITIONAL ADMISSION



HIGHLIGHTS

- Small classrooms and dedicated MA TESOL-trained instructors.
- Seamless transition from the English Language Institute to your academic program. No need for additional tests!
- Cultural orientation and excursions to historical and cultural sites.



CONDITIONAL ADMISSION FOR DEGREE APPLICANTS:

Students in levels 5 and 6 are able to concurrently enroll in academic classes for credit towards a degree program.

ENGLISH PROFICIENCY

Achieve a qualifying score on a recognized English language proficiency test:

- **Full Admission UG:** 70 iBT, 6.0 IELTS, 105 Duolingo, 50 PTE, 169 Cambridge, 4.0 ITEP, 2A STEP-EIKEN
- **Full Admission G:** 81 iBT, 6.5 IELTS, 115 Duolingo, 58 PTE, 177 Cambridge, 4.5 ITEP, Pre-1 STEP-EIKEN

Find more criteria on the website:
www.millersville.edu/englishproficiency

TO OBTAIN AN I-20 (CERTIFICATE OF ELIGIBILITY)

- Copy of passport
- Proof of financial support/source of funds

SEMESTER START DATE

International students are eligible to begin their program of study in the fall (August) or spring (January) semester each year. The academic year begins in the fall semester. Master of Social Work students only begin their studies on campus during the summer 1 term (May).



ENGLISH
LANGUAGE INSTITUTE
— Millersville University —

SCAN QR CODE
IN ORDER
TO CONTACT
OUR TEAM!



Schedule a Meeting

We know that exploring your educational options in the USA can be confusing – we are here to help!

Scan the QR code to choose a date and time that works best for you. Meetings will be approximately 15 to 30 minutes long.

Meeting with our International Admissions team, you can talk about the application process, financial aid, or other admission decision-related concerns or questions. Visit **www.millersville.edu/ipsm** to get started.

SCAN HERE



Millersville University

International Programs & Services • Millersville, PA – USA
717-871-4625 • internationaladmissions@millersville.edu



@millersvilleu



@millersvilleu



@millersvilleu